

DRAWING NUMBER  
**DS509352**

**DATA SHEET**

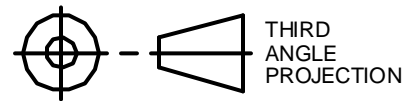

USED ON  
X1583

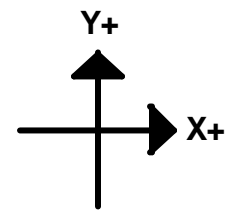

D or  
CAT.No  
-

M.A./S.A.

SPECIFICATION

- BODY ~ MOULDED RIGID PLASTIC BODY, COLOUR: BLACK
- BALL SEAL ~ RUBBER BALL SEAL/RESTRAINING RING (REMOVABLE), BLACK
- BALL ~ Ø2", COLOUR: BLACK
- RESOLUTION ~ 960 EDGES PER BALL REVOLUTION
- CONNECTOR ~ 6 PIN, 90° HEADER, 2.5 PITCH, MOLEX 5046 SERIES
- SUPPLY ~ +5V D.C. ±5% @ 50mA MAX.
- OUTPUT ~ UNIT WILL AUTODETECT TO EITHER PS2 OR USB  
DEPENDANT ON HOST.
- PERFORMANCE ~ MAXIMUM BALL SPEED IS 300RPM.

CONNECTION DETAILS

SWITCH INPUT (P1)		SERIAL OUTPUT (P2)	
PIN	DESCRIPTION	PIN	DESCRIPTION
1	0V GND	1	- DATA/DATA (USB/PS2)
2	LEFT SWITCH	2	+ DATA/CLOCK (USB/PS2)
3	0V GND	3	EARTH GROUND
4	RIGHT SWITCH	4	+5V
5	0V GND	5	SIGNAL GROUND
6	MIDDLE SWITCH	6	EARTH GROUND

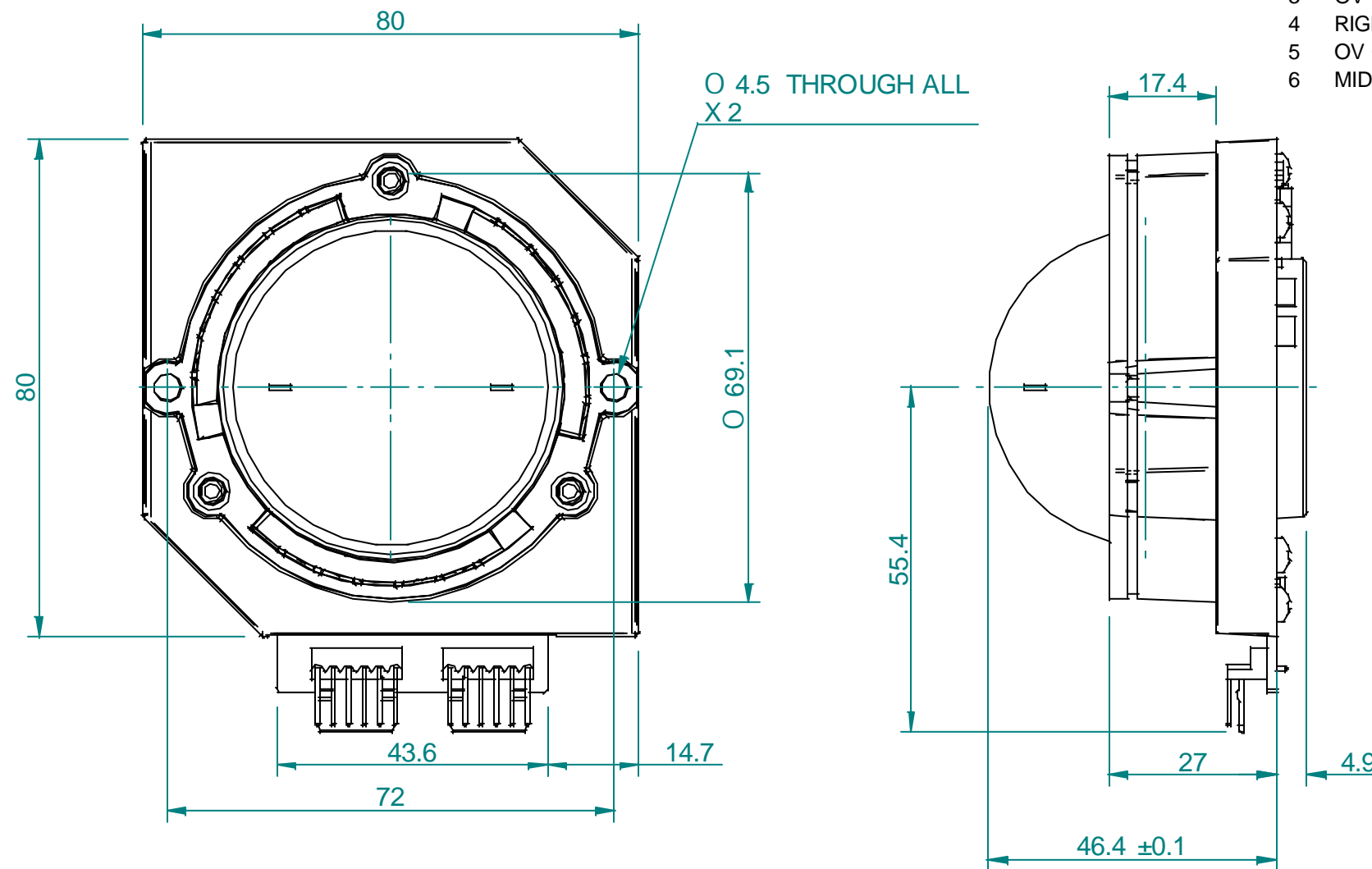

NOTE: THE DEVICE IS AVAILABLE WITH A NUMBER OF DIFFERENT OPTIONAL EXTRAS. THESE ARE DESCRIBED ON SUBSEQUENT PAGES. SHOWN BELOW ARE THE RELEVANT ORDER CODES FOR EACH REQUIRED OPTIONAL EXTRA.

OPTION	DESCRIPTION	ORDER CODE
A	LIP SEAL	ORG-SA-077-949/02
B	LOWER COVER	ENC-CP-078-319/01
C	DRAINAGE TUBE	ENC-CP-078-198/01
D	DRAINAGE PLUG	ENC-CP-078-120/01
E	BALL RETAINER RING	ORG-SA-078-303/01
F	SEALING GASKET	GKT-CP-076-225

APP.	MATERIAL	FINISH	TOL. ±0.2	SCALE 1:1 DIMNS MM	ISSUE	A	B	1	2	3		
CHKD.					DATE	20.07.04	22.07.04	10.02.06	20.02.06	10.07.06		
					CHANGE	NEW DWG	NEW DWG	PROD ISS	ECN1363	ECN1397		



Esterline Corporation  
Ringwood, Hants, UK. BH24 1EU.  
Web: www.traxsys.com Email: sales@traxsys.com  
Tel: +44 (0) 1425 463100 Fax: +44 (0) 1425 463111

TITLE  
**2" STANDARD INDUCTIVE  
TRACKBALL  
(TBPS/50/P1/UP2/9352)**

SIZE  
**A3**

DRAWING NUMBER

**DS509352**

DRAWING NUMBER  
DS509352

**DATA SHEET**

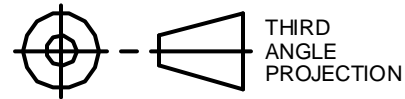

USED ON  
X1583

D or  
CAT.No  
-

M.A./S.A.

**OPTION A: LIP SEAL**

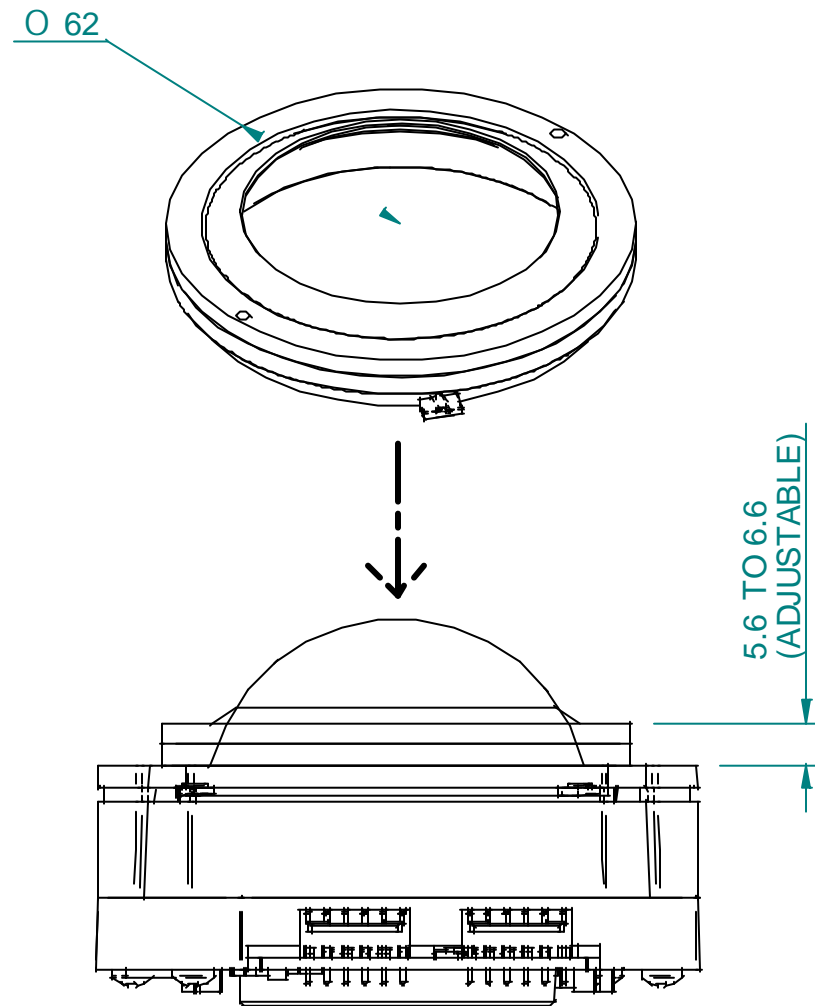

**OPTION B: LOWER COVER**

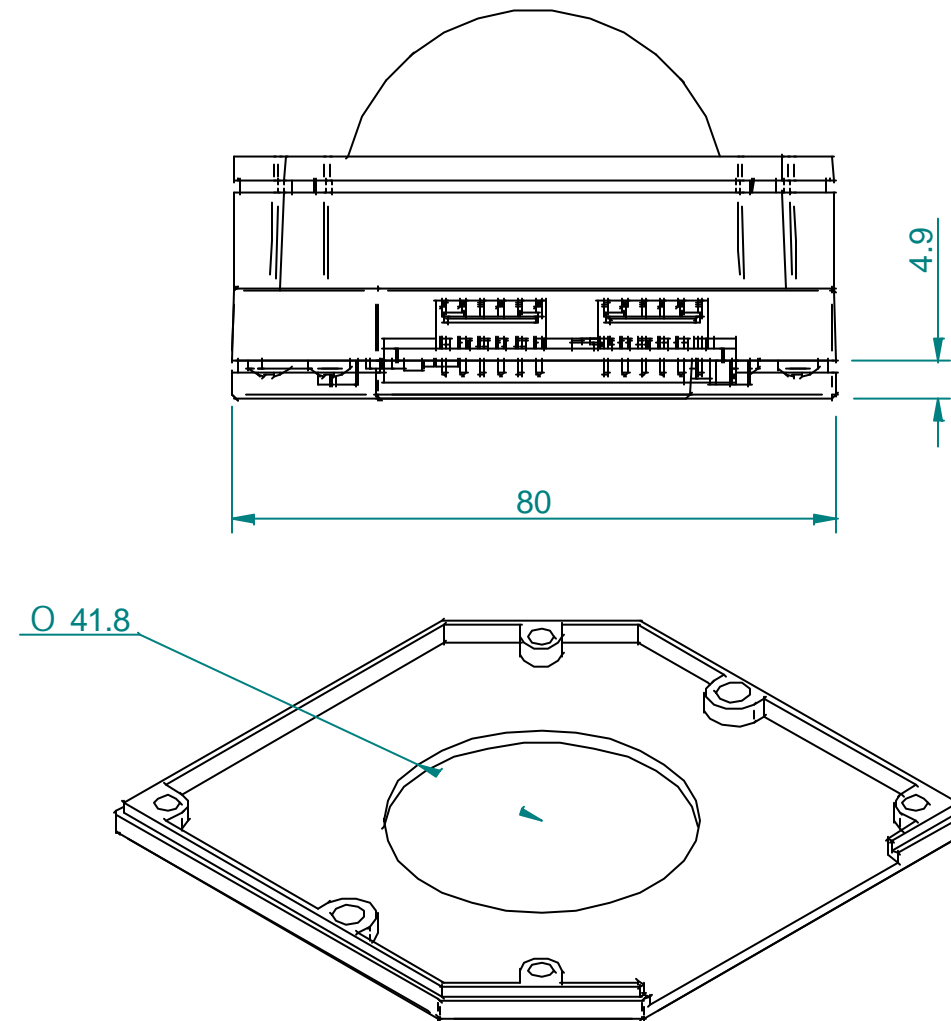

APP.	MATERIAL	FINISH	TOL. ±0.2	SCALE 1:1 DIMNS MM	ISSUE	A	B	1	2	3		
CHKD.					DATE	20.07.04	22.07.04	10.02.06	20.02.06	10.07.06		
DRAWN A. ROACH					CHANGE	NEW DWG	NEW DWG	PROD ISS	ECN1363	ECN1397		



Esterline Corporation  
Ringwood, Hants, UK. BH24 1EU.  
Web: www.traxsys.com Email: sales@traxsys.com  
Tel: +44 (0) 1425 463100 Fax: +44 (0) 1425 463111

TITLE  
**2" STANDARD INDUCTIVE TRACKBALL**  
**(TBPS/50/P1/UP2/9352)**

SIZE  
A3

DRAWING NUMBER  
DS509352

DRAWING NUMBER  
DS509352

**DATA SHEET**

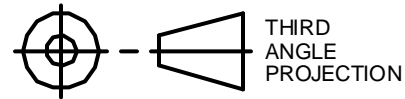

USED ON  
X1583

D or  
CAT.No  
-

M.A./S.A.

**OPTION C: DRAIN TUBE**

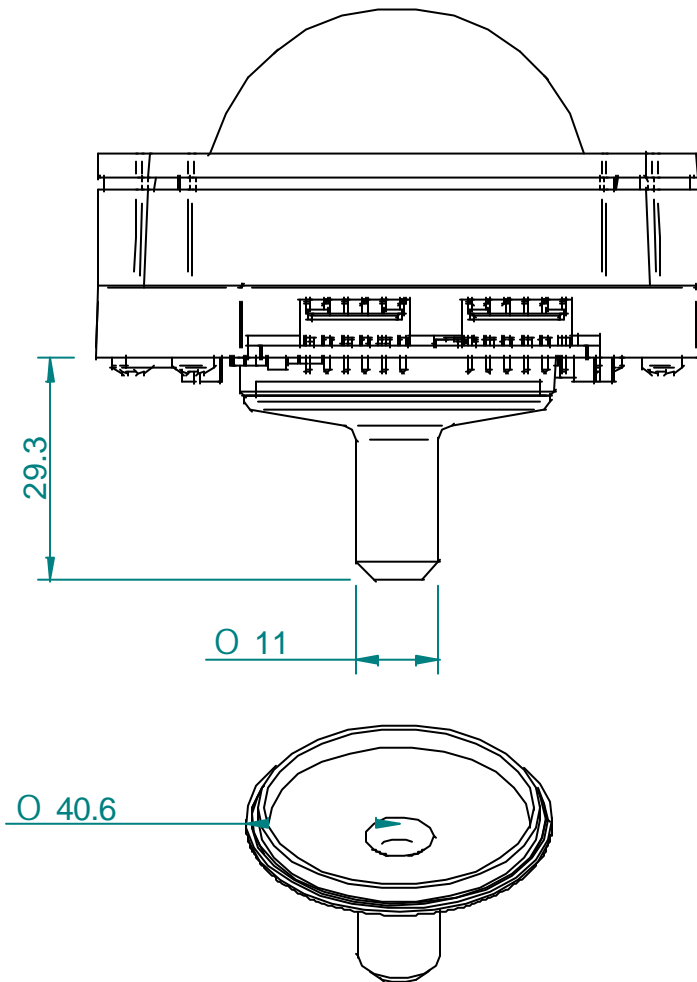

NOTE: THIS PART IS WELDED TO THE TRACKBALL BODY.

**OPTION D: PLUG**

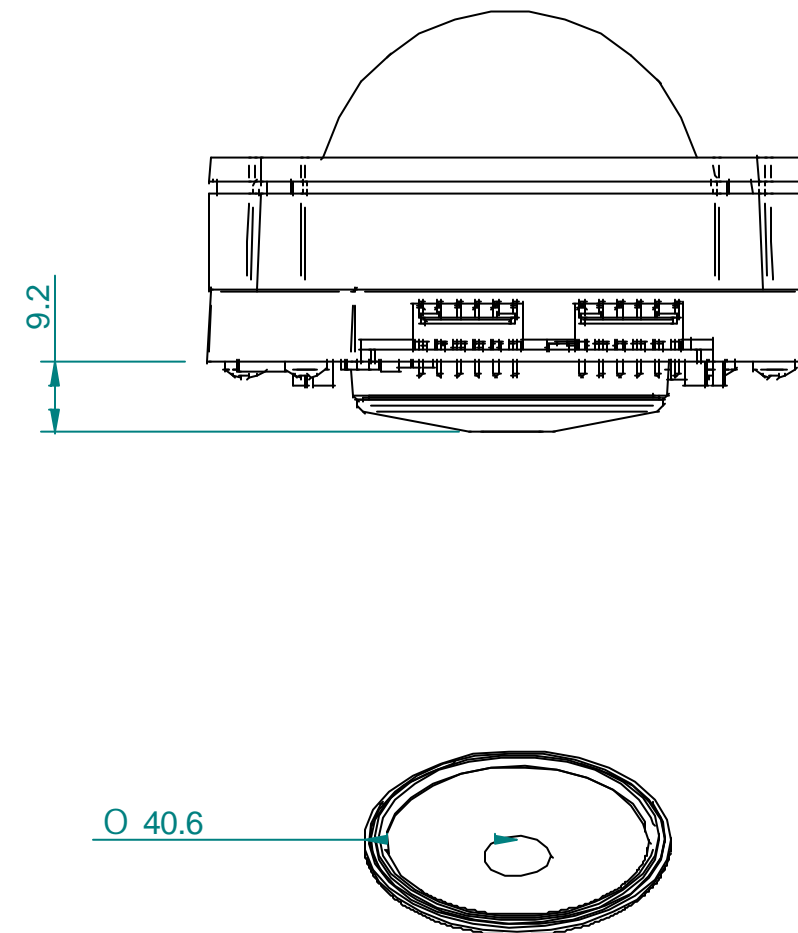

NOTE: THIS PART IS WELDED TO THE TRACKBALL BODY.

APP.	MATERIAL	FINISH	TOL. ±0.2	SCALE 1:1 DIMNS MM	ISSUE	A	B	1	2	3		
CHKD.					DATE	20.07.04	22.07.04	10.02.06	20.02.06	10.07.06		
DRAWN A. ROACH					CHANGE	NEW DWG	NEW DWG	PROD ISS	ECN1363	ECN1397		



Esterline Corporation  
Ringwood, Hants, UK. BH24 1EU.  
Web: www.traxsys.com Email: sales@traxsys.com  
Tel: +44 (0) 1425 463100 Fax: +44 (0) 1425 463111

TITLE  
**2" STANDARD INDUCTIVE TRACKBALL**  
**(TBPS/50/P1/UP2/9352)**

SIZE  
A3

DRAWING NUMBER

DS509352

DRAWING NUMBER  
DS509352

**DATA SHEET**

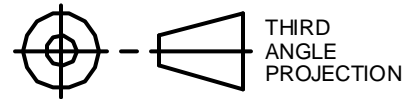

USED ON  
X1583

D or  
CAT.No  
-

M.A./S.A.

**OPTION E: BALL RETAINER RING**

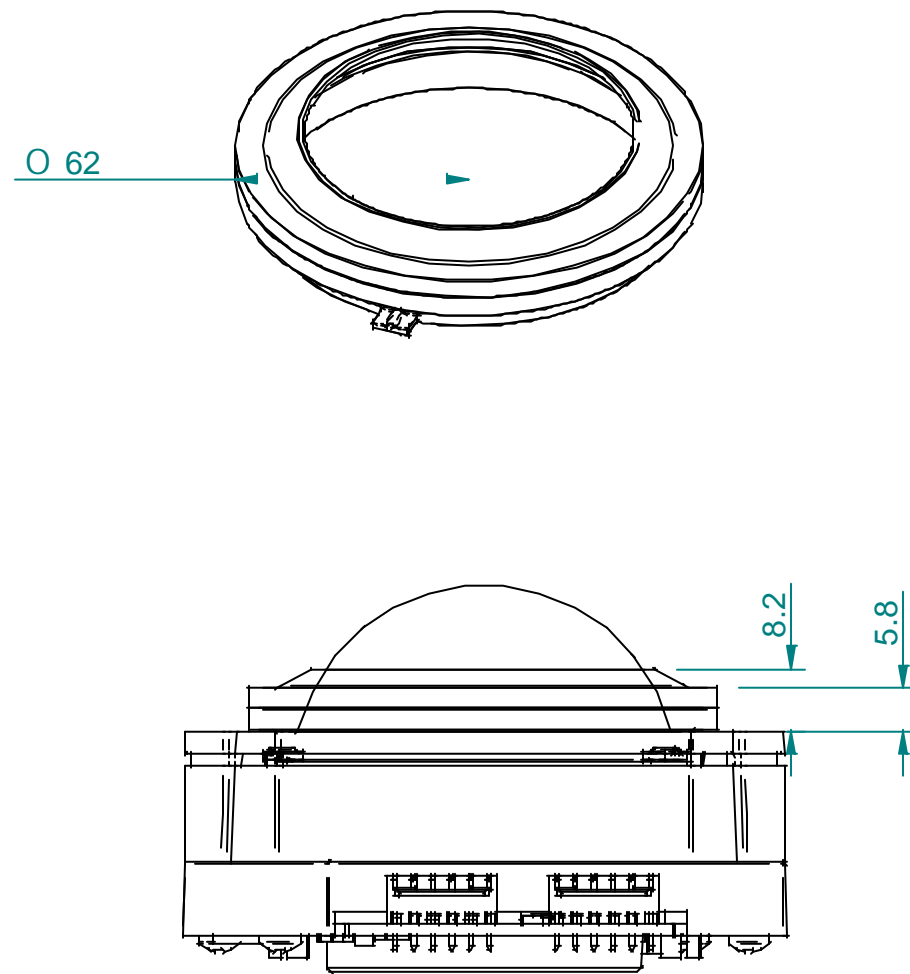

**OPTION F: SEALING GASKET**

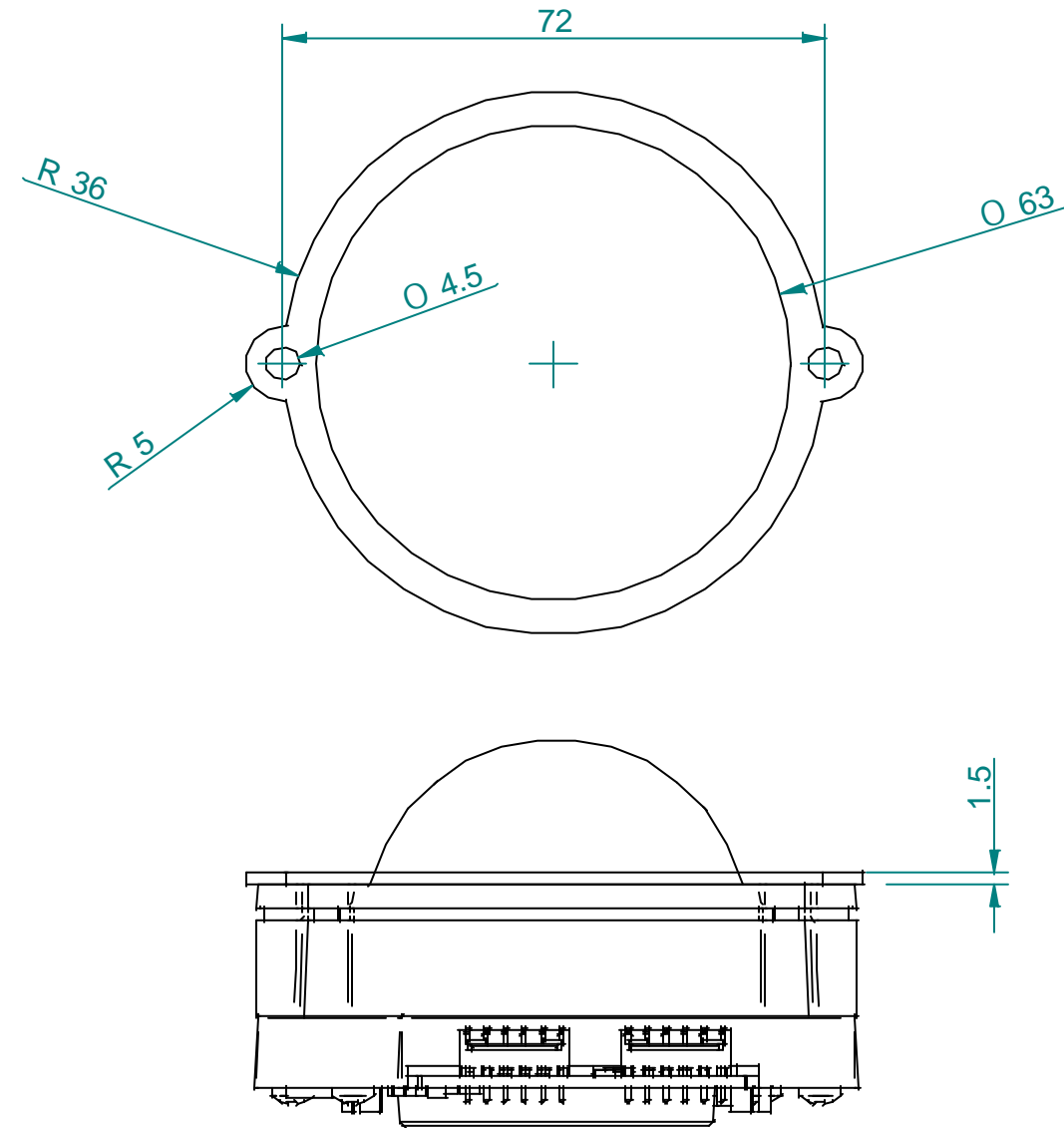

APP.	MATERIAL	FINISH	TOL. ±0.2	SCALE 1:1 DIMNS MM	ISSUE	A	B	1	2	3		
CHKD.					DATE	20.07.04	22.07.04	10.02.06	20.02.06	10.07.06		
DRAWN A. ROACH					CHANGE	NEW DWG	NEW DWG	PROD ISS	ECN1363	ECN1397		



Esterline Corporation  
Ringwood, Hants, UK. BH24 1EU.  
Web: www.traxsys.com Email: sales@traxsys.com  
Tel: +44 (0) 1425 463100 Fax: +44 (0) 1425 463111

TITLE  
**2" STANDARD INDUCTIVE  
TRACKBALL  
(TBPS/50/P1/UP2/9352)**

SIZE  
A3

DRAWING NUMBER  
**DS509352**